

BANGOR PUNTA MARINE
848 AIRPORT ROAD
FALL RIVER, MA 02722
(617) 678-5291



BANGOR
PUNTA
MARINE

C O N G R A T U L A T I O N S

In choosing your new yacht from the Cal line, you have selected one of the best values in today's sailboat market. The design and construction of this yacht reflect over twenty years of experience and knowledge gained in the building of over 10,000 boats.

In the early 1940's, William Lapworth designed "Dasher" and the "L-36," the forerunners of today's light displacement boats. Continuing in the traditional standards of high quality and fine workmanship, Bangor Punta Marine has commissioned over twenty models of his design.

The use of aluminum, stainless steel, teak wood, and fiberglass all combine to produce a yacht that has much lower maintenance requirements than those in the past. However, it is vital that the necessary maintenance procedures be performed faithfully.

This manual is designed to familiarize you with your boat. The location and function of each system onboard will be outlined to help make any adjustments or maintenance procedures more easily undertaken.

Bangor Punta Marine reserves the right to change specifications without notice, and this manual may not reflect all such changes. Since we are always striving to improve our product, modifications

and improvements are constantly in process and, therefore, it is possible that your boat may contain features different from those enumerated in this manual. It is impractical to revise this manual for each such modification. It is our policy to make improvements whenever it is appropriate without waiting for corresponding updates in our manual.

Full information on optional equipment may not be contained herein. Contact the option manufacturer or your Cal boat dealer for more information.

Please read and understand this manual and all others included with your boat, before operating any of the boat's systems. In addition to information contained in this manual, there are certain federal, state, and local regulations pertaining to safe and legal operation of pleasure craft that you should familiarize yourself with. Local governmental agencies and boating groups can help you become aware of these regulations.

Thank you for the confidence you have shown in Cal by selecting one of our products.

Have Fun, and Good Sailing!

BANGOR PUNTA MARINE

C O N T E N T S

I	GENERAL
	Standard Boat Dimensions
	Docking Plan
	Sail Plan
	Arrangement Plan
	Blank Interior Layout
	Dealer Responsibilities
	Owner's Responsibilities
	Limited Warranty
	Authorized Service Centers
II	COMMISSIONING
	Commissioning
	Pre-Launch Check List
	Post-Launch Check List
	Commissioning Notes
	Kenyon Mast Collar Installation Instructions(39/35)
	Stepping and Tuning the Mast
	Rigging Dimensions
	Wire Rigging
	Rope Rigging
	Boat Storage
III	OPERATION
	Engine Operating Instructions
	Flooding of Engine with Water
	Fuel System Diagram
	Fueling Procedure
	Steering Gear (39/35/31)
	Electrical
	Electrical Schematic
	Lightning Ground
	Navigation Lights
	Water Pressure System Plan
	Cooking Stoves/Propane Stove
	Alcohol Stoves
	Plumbing - Heads
	Plumbing - Fresh-Water System
	Thru-Hull Locations Plan
IV	MAINTENANCE
	Periodic Maintenance
	Periodic Maintenance Schedule
	Basic Rules for Battery Care and Maintenance
	Finishes
V	MANUALS

CAL 39

STANDARD BOAT DIMENSIONS

HULL DIMENSIONS

o LOA	39'0"	11.89 Meters
o LWL	32'1"	9.78 Meters
o Beam	12'0"	3.66 Meters
o Draft	6'8" or 5'6"	2.03 Meters or 1.68 Meters
o Displacement	17000 Lbs.	7711.2 Kilograms
o Ballast	7000 Lbs.	3175.2 Kilograms

RIG DIMENSIONS

o I	50'0"	15.24 Meters
o J	16'8"	5.08 Meters
o P	44'0"	13.41 Meters
o E	13'9"	4.19 Meters
o 100% Foretriangle	417 Sq. Ft.	38.74 Sq. Meters
o Mainsail Area	303 Sq. Ft.	28.15 Sq. Meters
o Total	720 Sq. Ft.	66.89 Sq. Meters
o Mast Height Above Water	55'	16.76 Meters

MISCELLANEOUS

o Berths	6	6
o Fresh Water Capacity	130 Gallons	494 Liters
o Ice Box Capacity	8.0 Cubic Ft.	226.6 Liters
o Fuel Capacity	45 Gallons	171 Liters
o Engine	Pathfinder 4 cylinder fresh water cooled diesel engine- 40HP.	

Cal 39 Standard Rig

I	50'0"
J	16'8"
P	44'0"
E	13'9"
100% Foretriangle	417 Sq. Ft.
Mainsail Area	303 Sq. Ft.
Total	720 Sq. Ft.

Cal 39 Tall Rig

I	54'0"
J	16'8"
P	48'0"
E	13'9"
100% Foretriangle	450 Sq. Ft.
Mainsail Area	330 Sq. Ft.
Total	780 Sq. Ft.

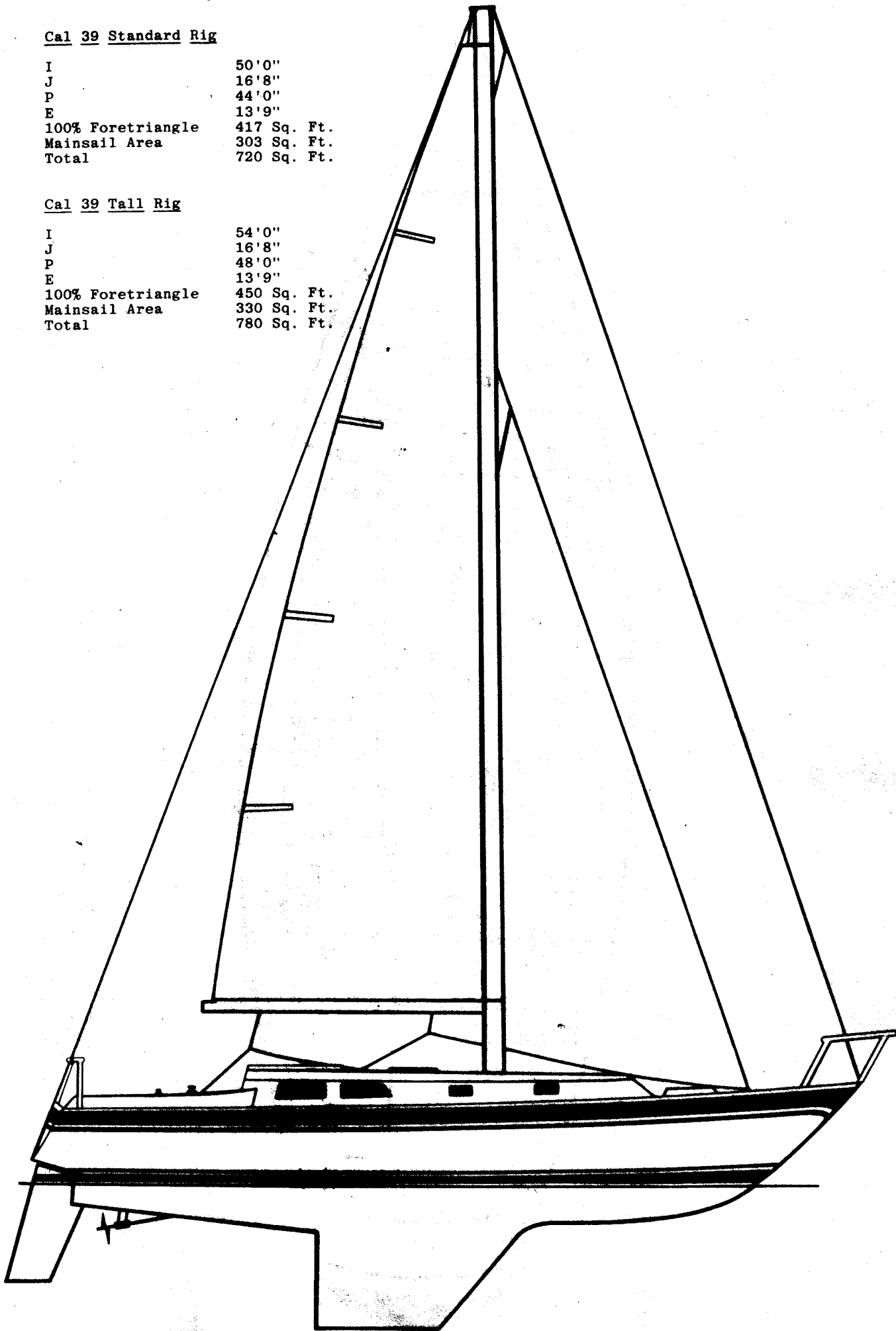

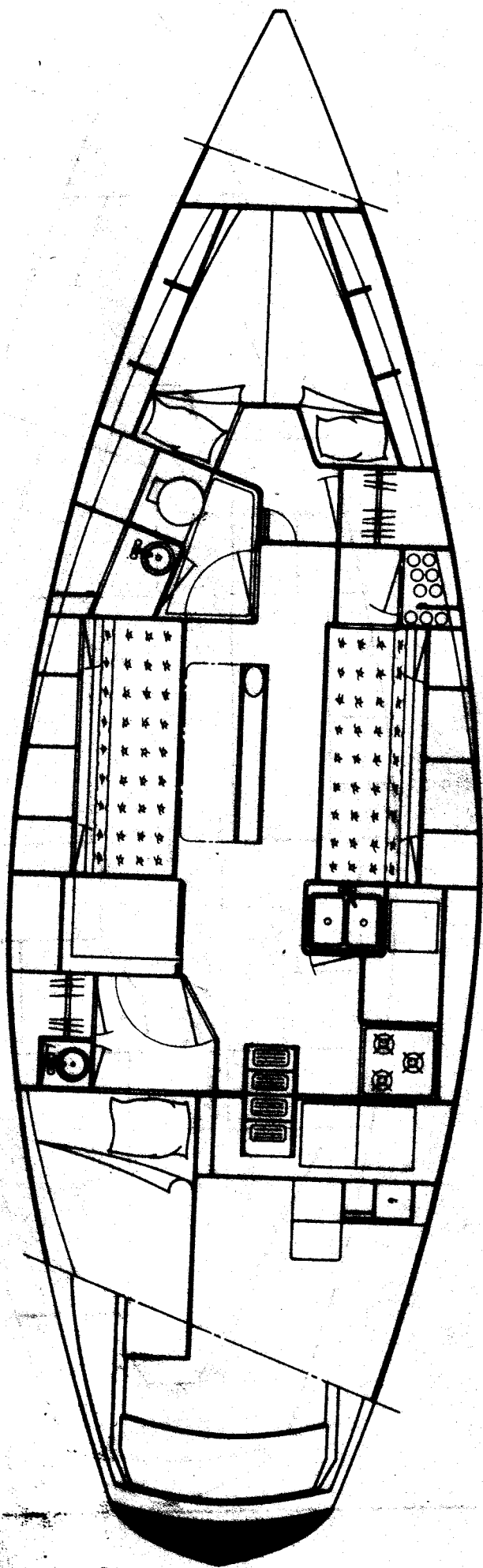

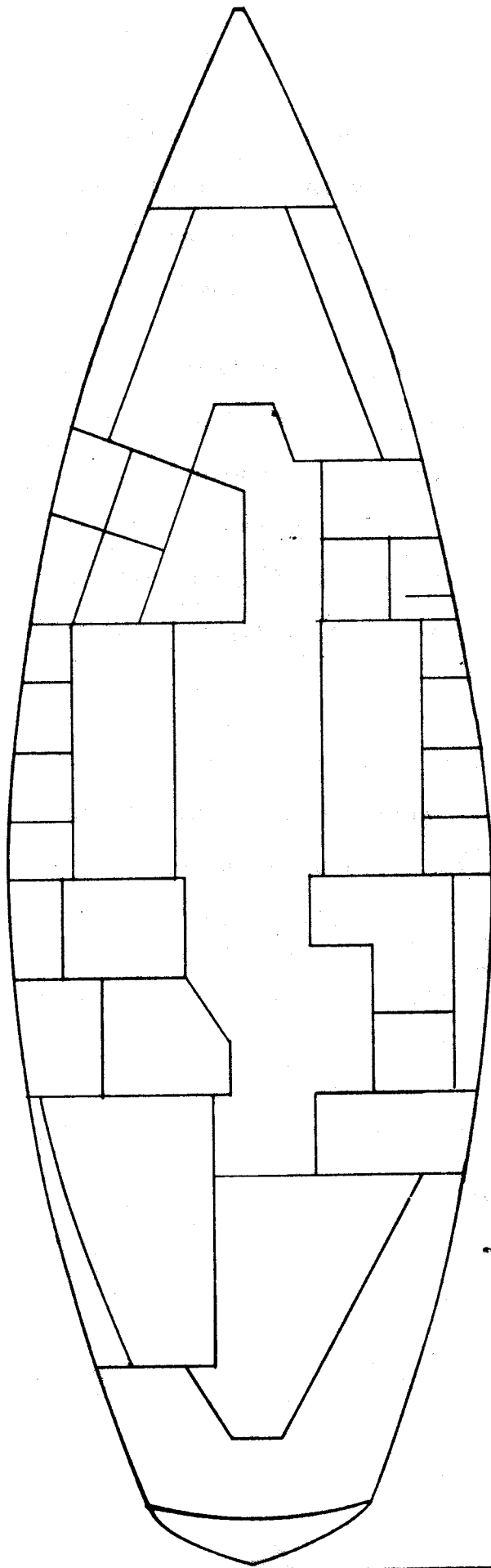

ORIG	RELEASED OWNERS MANUAL	7-1780
REV	DESCRIPTION	DATE
	INTERIOR LAYOUT BLANK	
	CAL 39 MK III	
	DESIGN ROBIN DENSON MW	
	BANCOR PUNTA MARINE	
	BOAT NO 322	

DEALER RESPONSIBILITIES

Your Cal boat dealer is a professional. He can provide you with the service and expertise that will help you to enjoy your Cal. Rely on him for assistance in selecting any additional equipment you may need and in seeing that it is properly installed.

The dealer has inspected the boat upon arrival at his yard. When the boat is commissioned, he will check all the systems and equipment and correct any problems that may arise. Should there be any defects covered by the Cal warranty, the dealer will correct them as soon as possible and file any warranty claims with Bangor Punta Marine. All warranty matters must be handled by an authorized Cal dealer.

Should you need any parts for your Cal product, contact your local dealer. He can obtain quick delivery from Cal. By utilizing his assistance, you can be assured of receiving the proper parts and of proper installation as well.

Bangor Punta Marine assumes no liability for damage incurred in transit.

OWNER'S RESPONSIBILITIES

Your Cal yacht is covered by our Limited Warranty (see next page) for a period of one year after commissioning by the original retail customer, but in no event later than two years from the date of shipment by Bangor Punta Marine. Always refer to our Limited Warranty for complete warranty information. Within 30 days of taking delivery of your boat, fill out the warranty registration card and return it to Bangor Punta Marine. The U. S. Coast Guard requires that all manufacturers keep records of people who have purchased their products. This is necessary in case a defect notification or product recall is needed. The only way Bangor Punta Marine can maintain these files is to have you send in the completed card. If you have any questions or comments, please include these with the card. We will get back to you.

When you sell your Cal product, please drop us a note with the hull number, your name, and the name of the new owner.

It is important that you contact your dealer as soon as possible when product defects are noted. This will assure prompt service and prevent the problem from worsening.

Thoroughly check your ship's paper file to insure that all manuals and warranties for your optional or additional equipment are provided.

CAL

LIMITED WARRANTY

Bangor Punta Marine warrants each new Cal boat manufactured by it to be free from defects in material and workmanship, under normal noncommercial use and service, for a period of one year after commissioning by the original retail customer, but in no event later than two years from the date of shipment by Bangor Punta Marine, subject to the terms and conditions stated below.

- 1) **Warrantor.** This warranty is granted by Bangor Punta Marine, a division of Bangor Punta Corporation, 848 Airport Road, Fall River, Massachusetts 02722 and 200 Kalmus Drive, Costa Mesa, California 92626.
- 2) **Parties to Whom Warranty is Extended.** This warranty shall extend to any buyer (other than for purposes of resale or use in the ordinary course of the buyer's business), and any noncommercial transferee to whom such product is transferred during the warranty period and who normally uses it for personal, family or household purposes. For Cal boats used commercially, this warranty also extends but it expires thirty (30) days after commissioning by the original purchaser.
- 3) **Parts Covered.** All parts manufactured by Bangor Punta Marine, including the hull, deck, and cabinetry are covered by this warranty; the installation work performed by Bangor Punta Marine on components not manufactured by it, is also covered by this warranty.
- 4) **Parts Not Covered.** The following parts are not covered by this warranty:
 - a) masts, plywood, teak, external finishes (which include paint and gelcoat), and upholstery; and
 - b) engines, toilets, stoves, refrigerators, batteries, ignition systems, lighting devices, blowers, propellers, and other parts and equipment manufactured by others.

Bangor Punta Marine will forward the owner warranties, if any, extended by other manufacturers.

- 5) **Remedy.** If within the applicable warranty period any part or installation work covered by this warranty proves to be defective in material or workmanship, then Bangor Punta Marine shall, at its sole option, repair or replace the defective part. Parts and labor shall be at the expense of Bangor Punta Marine, but not transportation costs.
- 6) **Procedure for Obtaining Performance Under This Warranty.** In order to obtain performance of the obligations under this warranty, the owner must promptly (within thirty days of discovery of the defect) notify Bangor Punta Marine or an authorized Cal service center of the defect, and at Bangor Punta Marine's or the authorized Cal service center's direction, return the defective part or product to be repaired or replaced under this warranty to an authorized Cal service center. If repair or replacement by an authorized Cal service center is determined by Bangor Punta Marine to be impractical, the owner shall return the defective part or product to Bangor Punta Marine at either of the addresses stated above. All transportation costs to and from the authorized Cal service center or Bangor Punta Marine, and all haul-out, launching and rigging costs, will be at the expense of the owner.
- 7) **Sole Remedy.** The remedy and liability for any breach of warranty, express or implied, set forth above is the sole and exclusive remedy and the limit of liability for any such breach.
- 8) **Design Changes.** Bangor Punta Marine reserves the right to make changes in the design or material of its products without incurring any obligation to incorporate such changes in any product previously manufactured or advertised.
- 9) **Exclusions and Implied Warranties.** This warranty does not extend to any defect due to the negligence of others, failure to operate or maintain the product in accordance with the operation and maintenance instructions furnished with each new product, unreasonable use, accidents, alterations, or ordinary wear and tear. **ALL IMPLIED WARRANTIES, IF ANY, ARISING UNDER STATE LAW ARE LIMITED IN DURATION TO THE DURATION OF THIS WRITTEN WARRANTY. EXCEPT FOR SUCH IMPLIED WARRANTIES, THERE ARE NO OTHER WARRANTIES WHICH EXTEND BEYOND THIS WARRANTY. BANGOR PUNTA MARINE SHALL NOT BE RESPONSIBLE FOR LOSS OF USE OF ANY PRODUCT, LOSS OF TIME, INCONVENIENCE OR OTHER INCIDENTAL OR CONSEQUENTIAL DAMAGES WITH RESPECT TO BUSINESS OR PROPERTY, WHETHER AS A RESULT OF BREACH OF WARRANTY, NEGLIGENCE OR OTHERWISE.** Some states do not allow (a) limitations on how long an implied warranty lasts or (b) the exclusion or limitation of incidental or consequential damages, so the above limitations or exclusions may not be applicable. This warranty gives the owner specific legal rights, and there may also be other rights which vary from state to state.